

SEWAGE

Range Vortex NJ

Submersible
Pump for
Sewage Water

KEY ADVANTAGES OF A VORTEX PUMP:

Incolmatage : The vortex impeller creates a vortex that leads to most solids without contact with the turbine and the fibrous materials are repelled and can not hold on to the turbine.

Minimum wear + consistent performance: The Vortex pump wear is very low because most of the solids pumped passes through the volute without touching the turbine. The yield remains constant over a long period.

Low maintenance + no adjustment: The position of the wheel back in the volute eliminates the risk of blockage and sudden loss of performance. No adjustment is necessary and the cost of maintenance and operation are low and constant.

■ Vortex NJ : Vertical outlet

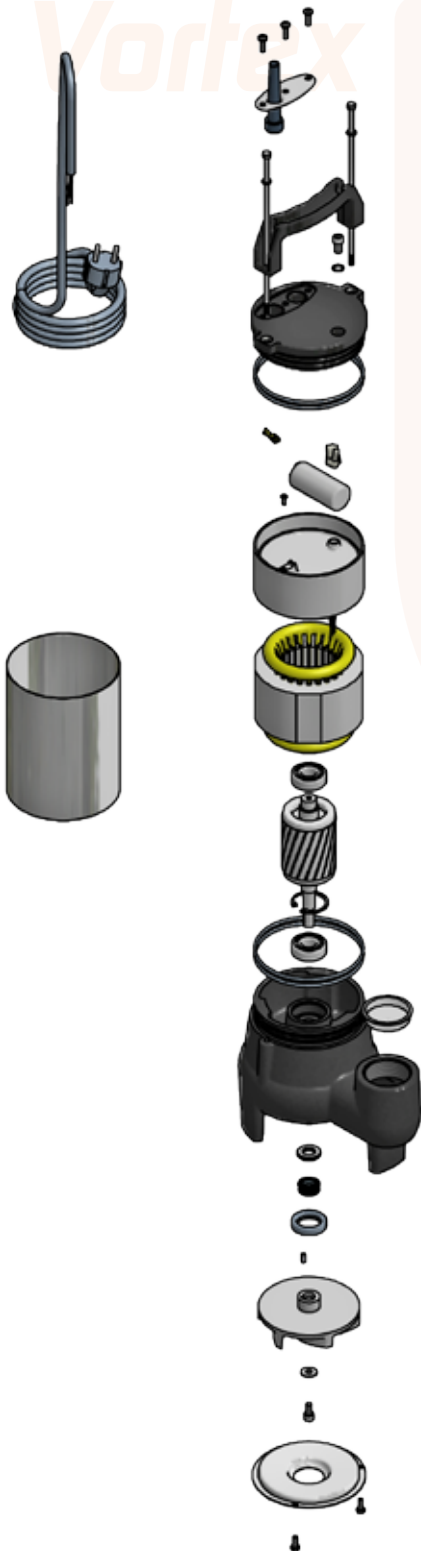

The range **Vortex NJ** is especially designed to meet the water loaded with suspended matter, all wastewater houses (excluding WC) From 30 mm passage. Very low electrical consumption. Adapted to the sludge recirculation for microstation

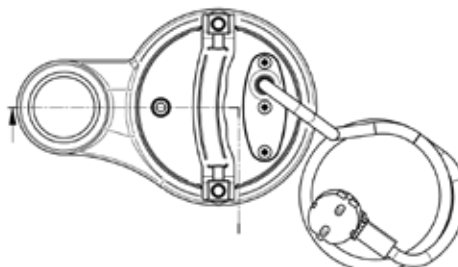
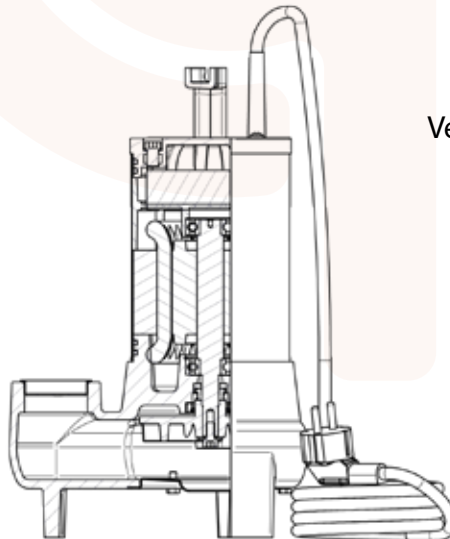

USE :

Laden water with suspended solids, sludge recirculation for microstation
 All wastewater from homes, except toilets from 30 mm to pass
 Immersion depth of 10 m

FEATURES :

- Motor casing in stainless steel
- Casing pump in cast
- Impeller in cast iron, stainless steel shaft
- Engine oil bath class F, 10 m cable, built-in capacitor (to phase)
- Double seals, lip seals and reinforced carbon ceramic mechanical seal
- Single-phase models with or without float float (types A)



SEWAGE
Vortex NJ

**Submersible
 Pump for
 Sewage Water**

Vertical outlet

Vortex

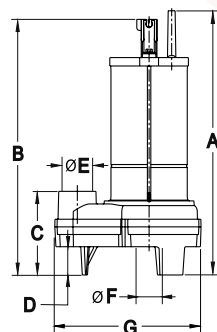
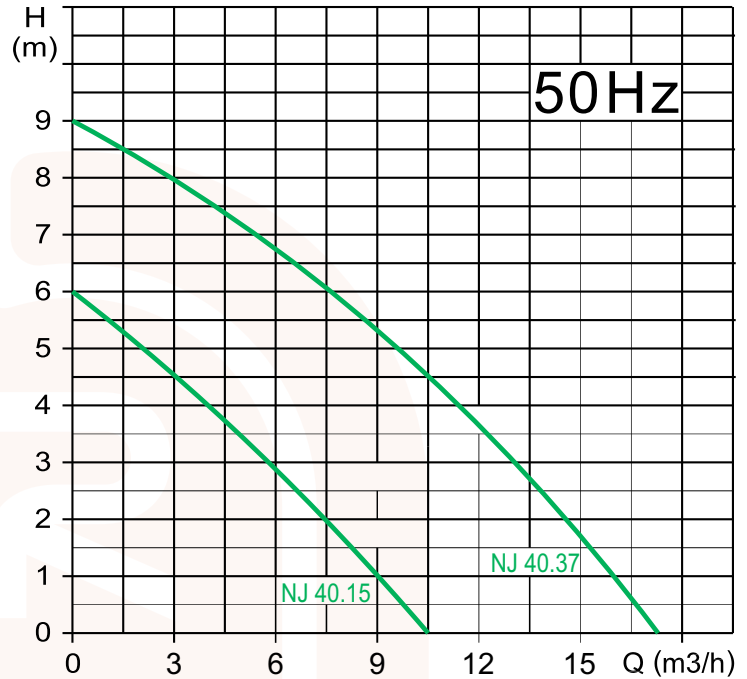

Type	Dimensions (mm)							Weight Kg
	A	B	C	D	øE	ø F (passage)	G	
NJ 40.15.	322	311	111	35	1"½	33	213	0
NJ 40.37.	347	335	111	35	1"½	33	213	0

Type	Tension	Power		Motor		Passage	Connection	H (max)	Debit (max)	Code	
	V	kW	CV	A	µF						
NJ 40.15.1M	1 x 230	0,15	0,2	2	12	30	1"½	6	9,6	01011051	
NJ 40.15.1A	1 x 230	0,15	0,2	2	12	30	1"½	6	9,6	01011052	
NJ 40.15.3	3 x 400	0,15	0,2	1	-	30	1"½	6	9,6	01011053	
NJ 40.37.1M	1 x 230	0,37	0,5	3,4	16	30	1"½	9	16,7	01011027	
NJ 40.37.1A	1 x 230	0,37	0,5	3,4	16	30	1"½	9	16,7	01011028	
NJ 40.37.3	3 x 400	0,37	0,5	1,3	-	30	1"½	9	16,7	01011029	

Built-in capacitor for single-phase models - Type A: model with float switch

SEWAGE

Range Vortex N

Submersible
Pump for
Sewage Water

KEY ADVANTAGES OF A VORTEX PUMP:

Incolmatage : The vortex impeller creates a vortex that leads to most solids without contact with the turbine and the fibrous materials are repelled and can not hold on to the turbine.

Minimum wear + consistent performance: The Vortex pump wear is very low because most of the solids pumped passes through the volute without touching the turbine. The yield remains constant over a long period.

Low maintenance + no adjustment: The position of the wheel back in the volute eliminates the risk of blockage and sudden loss of performance. No adjustment is necessary and the cost of maintenance and operation are low and constant.

Vortex N : Vertical outlet

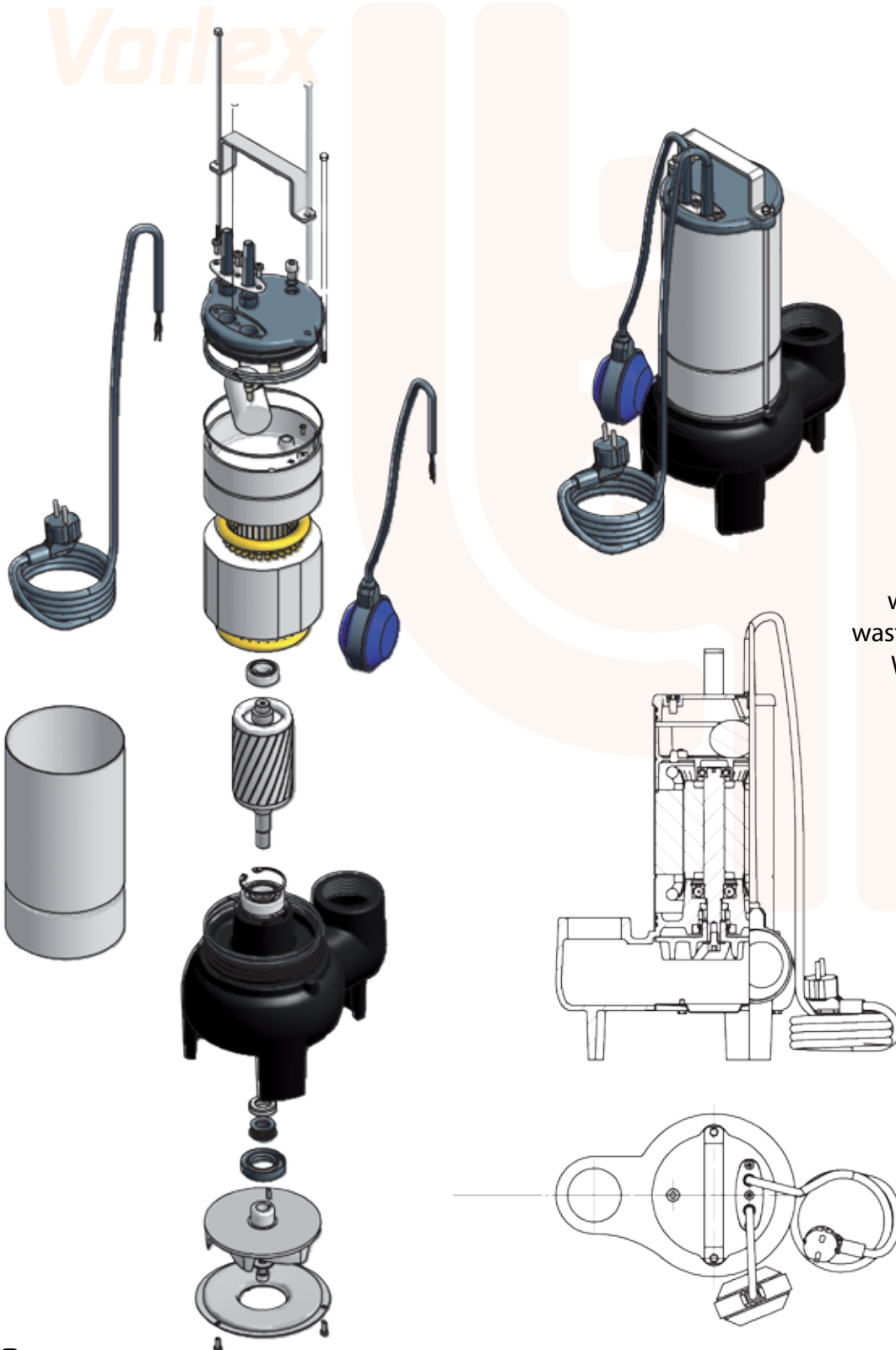

The range **Vortex N** is especially designed to meet the water loaded with suspended matter, all wastewater houses (including WC) from 50 mm passage.

USE :

Laden water with suspended solids
 All wastewater from homes, including toilets from 50 mm to pass
 Immersion depth of 10 m

FEATURES :

Motor casing in stainless steel
 Casing pump in cast iron
 Impeller in cast iron, stainless steel shaft
 Engine oil bath class F, 10 m cable, built-in capacitor (to phase)
 Double seals, lip seals and reinforced carbon ceramic mechanical seal
 Single-phase models with or without float float (types c / b)



SEWAGE
Vortex N

**Submersible
 Pump for
 Sewage Water**

Vertical outlet

Vortex

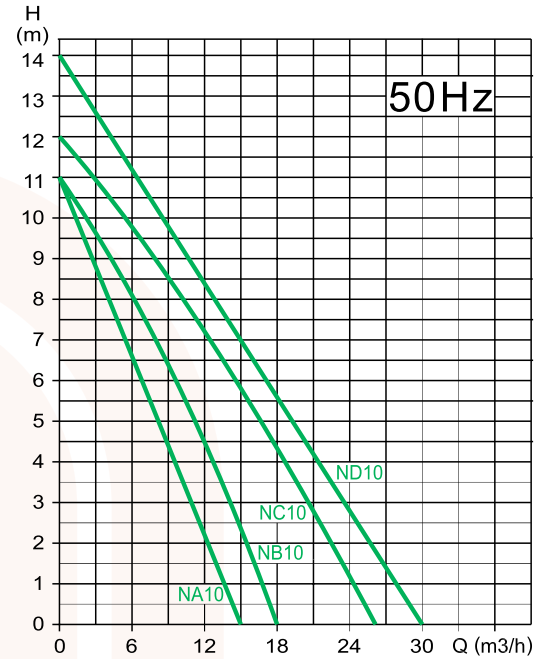
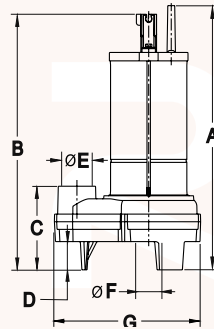

Type	Dimensions (mm)							Weight Kg
	A	B	C	D	øE	ø F (passage)	G	
NA 10	345	335	110	37	1"¼	33	215	10,5
NB 10	365	355	120	42	1"½	35	230	11,5
NC 10	425	410	137,5	53	2"	50	255	17,0
ND 10	435	420	137,5	53	2"	50	255	19,0

Type	Tension V	Power		Motor		Passage ø mm	Connection DN	H (max) m	Debit (max) m³/h	Code
		kW	CV	A	µF					
NA 35.60.1M	1 x 230	0,6	0,8	5,2	16	33	1"¼	11	15	01010671
NA 35.60.1A	1 x 230	0,6	0,8	5,2	16	33	1"¼	11	15	01010668
NA 35.60.3	3 x 400	0,6	0,8	1,4	-	33	1"¼	11	15	01010674
NB 40.75.1M	1 x 230	0,75	1	6,4	20	35	1"½	11	18	01010680
NB 40.75.1A	1 x 230	0,75	1	6,4	20	35	1"½	11	18	01010677
NB 40.75.3	3 x 400	0,75	1	2,6	-	35	1"½	11	18	01010683
NC 50.110.1M	1 x 230	1,1	1,5	9,0	35	50	2"	12	26	01010689
NC 50.110.1A	1 x 230	1,1	1,5	9,0	35	50	2"	12	26	01010686
NC 40.110.3	3 x 400	1,1	1,5	3,0	-	50	2"	12	26	01010692
ND 50.150.1M	1 x 230	1,5	2	9,4	40	50	2"	14	30	01010752
ND 50.150.1A	1 x 230	1,5	2	9,4	40	50	2"	14	30	01010366
ND 50.150.3	3 x 400	1,5	2	3,7	-	50	2"	14	30	01010701

Built-in capacitor for single-phase models - Type A: model with float switch

SEWAGE

Range Vortex NR

Submersible
Pump for
Sewage Water

KEY ADVANTAGES OF A VORTEX PUMP:

Incolmatage : The vortex impeller creates a vortex that leads to most solids without contact with the turbine and the fibrous materials are repelled and can not hold on to the turbine.

Minimum wear + consistent performance: The Vortex pump wear is very low because most of the solids pumped passes through the volute without touching the turbine. The yield remains constant over a long period.

Low maintenance + no adjustment: The position of the wheel back in the volute eliminates the risk of blockage and sudden loss of performance. No adjustment is necessary and the cost of maintenance and operation are low and constant.

■ Vortex NR : Vertical outlet

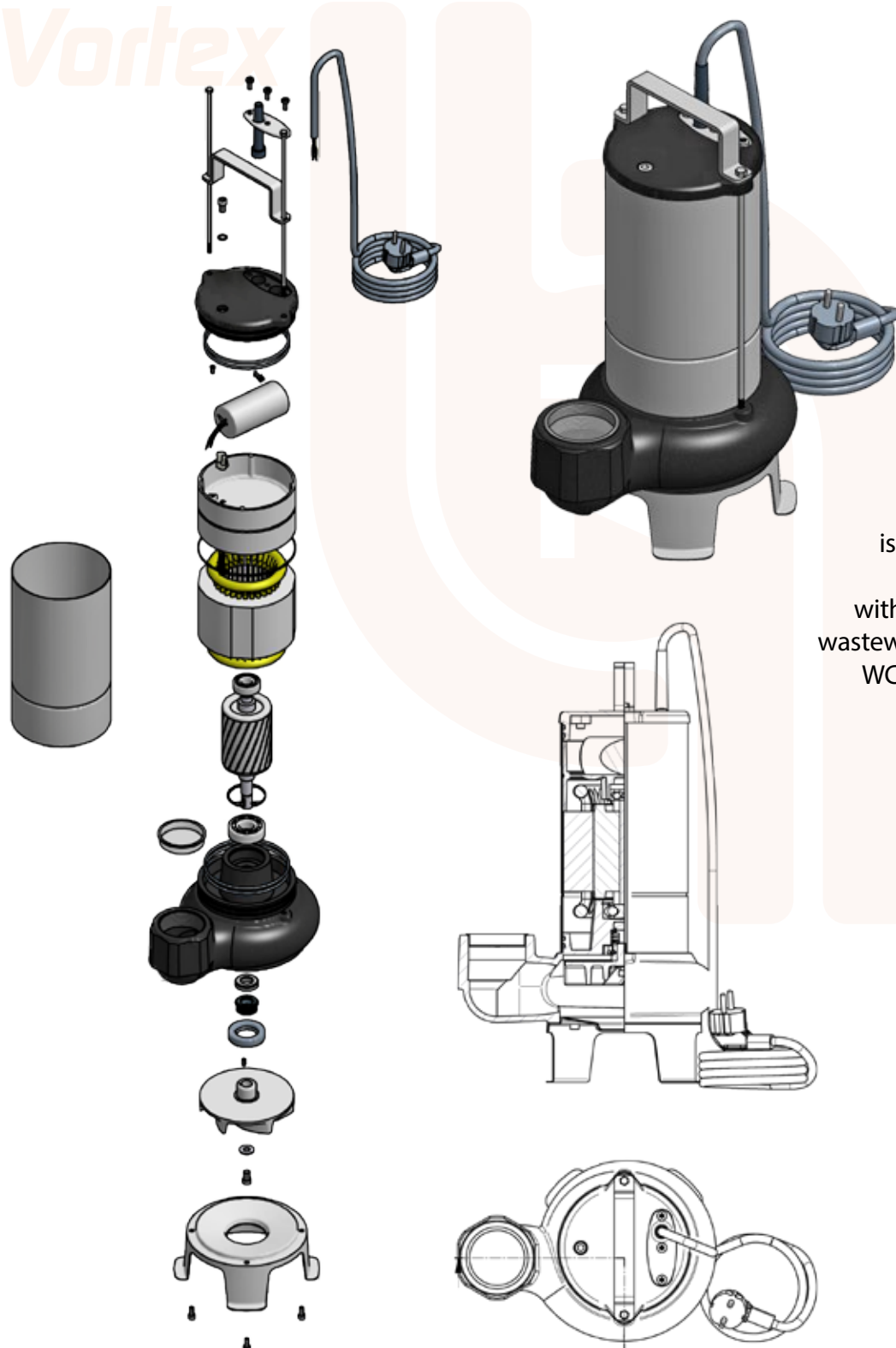

The range **Vortex NR** is especially designed to meet the water loaded with suspended matter, all wastewater houses (including WC) with 50 mm passage.

USE :

Laden water with suspended solids
 All wastewater from homes, including toilets from 50 mm to pass
 Immersion depth of 10 m

FEATURES :

Motor casing in stainless steel
 Pump head in cast. Casing and pump in cast and stainless steel
 Impeller in cast iron, stainless steel shaft
 Engine oil bath class F, 10 m cable, built-in capacitor (to phase)
 Double seals, lip seals and reinforced carbon ceramic mechanical seal
 Single-phase models with or without float float (types c / b)



SEWAGE Vortex NR

Submersible Pump for Sewage Water

Vertical outlet

Vortex

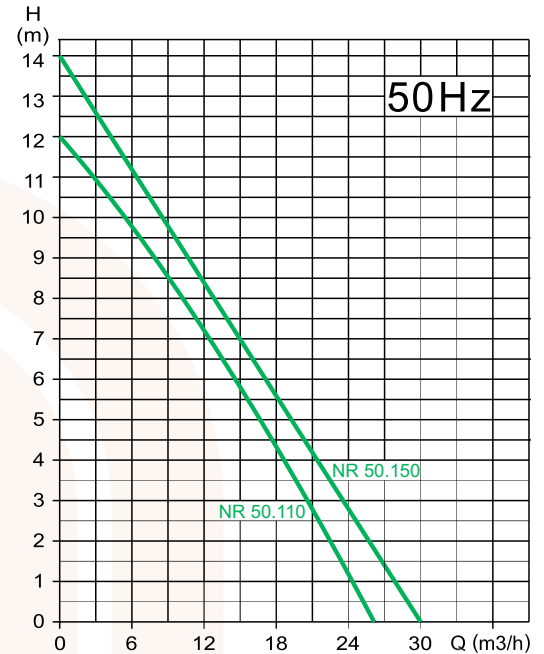
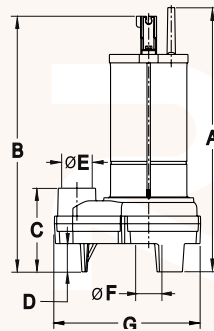

Type	Dimensions (mm)							Weight Kg
	A	B	C	D	ø E	ø F (passage)	G	
NR 50.110.	432	420	148	60	2"	50	252	0
NR 50.150.	442	430	148	60	2"	50	252	0

Type	Tension V	Power		Motor		Passage ø mm	Connection DN	H (max) m	Debit (max) m³/h	Code
		kW	CV	A	μF					
NR 50.110.1M	1 x 230	1,1	1,5	9,0	35	50	2"	12	26	01011019
NR 50.110.1A	1 x 230	1,1	1,5	9,0	35	50	2"	12	26	01011020
NR 50.110.3	3 x 400	1,1	1,5	3,0	-	50	2"	12	26	01011021
NR 50.150.1M	1 x 230	1,5	2	9,4	40	50	2"	14	30	01011022
NR 50.150.1A	1 x 230	1,5	2	9,4	40	50	2"	14	30	01011023
NR 50.150.3	3 x 400	1,5	2	3,7	-	50	2"	14	30	01011024

Built-in capacitor for single-phase models - Type A: model with float switch